

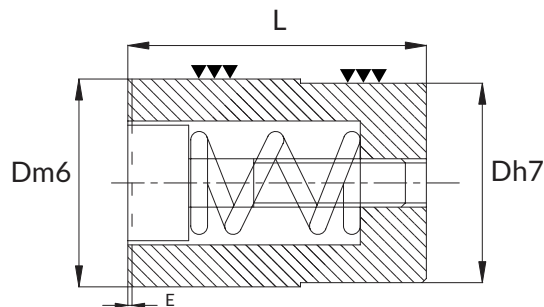

**DATARI A VITE**

**ELEMENTI NORMALIZZATI**

CORPI DATARI PER PLASTICA E PRESSOFUSIONE



**MATERIALE** : ACCIAIO 1.2343

**DUREZZA** : HRC 48 - 52

D	L+0,02	E
4	8	0,25
5	8	0,2
6	8	0,2
8	10	0,25
10	12	0,35
12	14	0,35
16	14	0,35
20	16	0,35

CORPO MESE	CORPO ANNO
CM04	CA04
CM05	CA05
CM06	CA06
CM08	CA08
CM10	CA10
CM12	CA12
CM16	CA16
CM20	CA20

CORPI DATARI PER PLASTICA E PRESSOFUSIONE SERIE LUNGA

D	L	E
5	17	0,2
6	17	0,2
8	20	0,25
10	20	0,35
12	25	0,35
16	33	0,35

CORPO MESE	CORPO ANNO
CM05L	CA05L
CM06L	CA06L
CM08L	CA08L
CM10L	CA10L
CM12L	CA12L
CM16L	CA16L

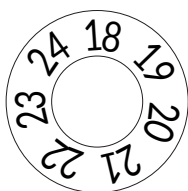

CORPO ANNO

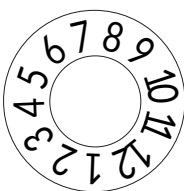

CORPO MESE

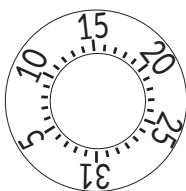

CORPO GIORNO

**INSERTI DATARI PER PLASTICA E PRESSOFUSIONE**

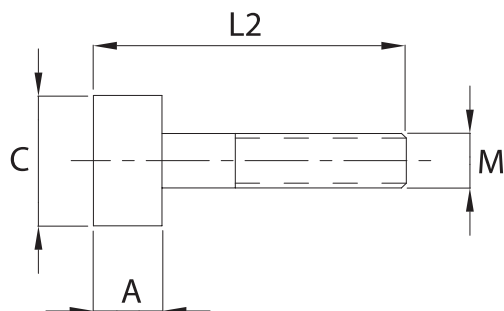

**MATERIALE :** ACCIAIO 1.2343  
**DUREZZA :** HRC 48 - 52

A	L2	C	FRECCIA ANNO	FRECCIA NEUTRA
2	8	2,2	FA04	FN04
2	8	3,1	FA05	FN05
2	8	3,1	FA06	FN06
2,5	10	4,4	FA08	FN08
3	12	5,2	FA10	FN10
3	14	6,2	FA12	FN12
3,5	14	8,2	FA16	FN16
4,5	16	11	FA20	FN20

**INSERTI DATARI PER PLASTICA E PRESSOFUSIONE SERIE LUNGA**

A	L2	C	FRECCIA ANNO	FRECCIA NEUTRA
3	13	3,1	FA05L	FN05L
3	13	3,1	FA06L	FN06L
4	14	4,6	FA08L	FN08L
4	14	4,6	FA10L	FN10L
4	17	6,4	FA12L	FN12L
5	23	8,4	FA16L	FN16L

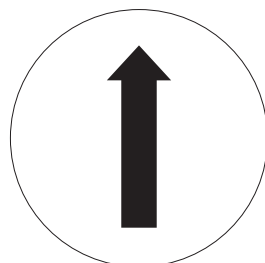
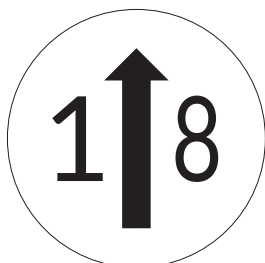



[www.eleenorm.com](http://www.eleenorm.com)