



# RACCORDI RAPIDI TIPO DME

ELEMENTI NORMALIZZATI



## ELEMENTI NORMALIZZATI RACCORDI RAPIDI TIPO DME

### SAFE-LOCK™

I prodotti contrassegnati da questo sistema sono dotati della tecnologia SAFE-LOCK™ sviluppata dai nostri progettisti.



Grazie a uno speciale meccanismo, la tecnologia SAFELOCK™ impedisce in modo affidabile lo sganciamento accidentale dei sistemi in pressione. Poiché le temperature normalmente contigue dei fluidi utilizzati sono comprese tra 90°C e 170°C, incidenti di questo tipo possono provocare gravi ustioni.

Le uniche alternative ai sistemi SAFE-LOCK™ sono i giunti a doppia chiusura, con i quali, tuttavia, la complessa tecnologia delle valvole ha un forte impatto negativo sui valori di portata.

### SISTEMI DI ACCOPPIAMENTO SAFE-LOCK

Elimina in modo affidabile il rischio di gravi ustioni.

Non possono essere scollegati sotto pressione.

Sono disponibili sia per il mercato europeo che per quello internazionale.

Sono compatibili al 100% con i nostri sistemi standard e, pertanto, possono essere facilmente installati anche in un secondo momento.

Sono resistenti all'olio e all'acqua fino a 140°C (picco 160°C)HT. Serie HT fino a 180°C.

Sono conformi alla direttiva UE sulla sicurezza 97/23/EF.

# Diametro nominale 20 / 30 / 50

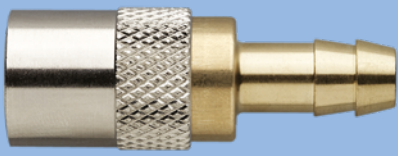

Series 20

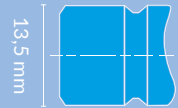

Series 30

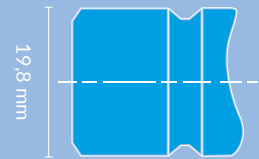

Series 50

## DESCRIZIONE TECNICA

Serie di raccordi sviluppata appositamente per il collegamento delle linee del refrigerante sugli stampi a iniezione.

Completamente intercambiabile con altre marche con gli stessi profili di innesto.

Tutte le dimensioni e le tolleranze sono conformi alle specifiche originali.

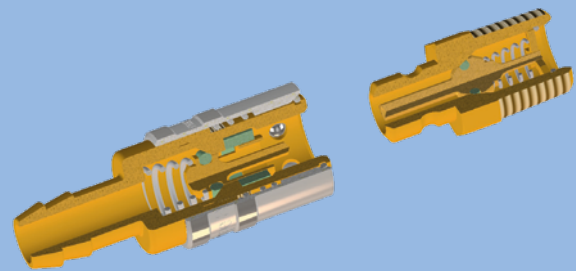

## MATERIALE

### INNESTO

Corpo posteriore: ottone

Corpo valvola: ottone

Manicotto: ottone (senza valvola)

Manicotto: ottone nichelato (con valvola)

Sfere di bloccaggio: AISI 420

Molla: AISI 301

### RACCORDO

Profilo della spina: Ottone

Corpo posteriore Ottone

Valvola: Ottone

Molla: AISI 301

Guarnizione: FKM

## PRESSIONE DI LAVORO

15 bar, pressione statica massima di esercizio con fattore di sicurezza di 4 a 1.

## TEMPERATURA DI LAVORO

Accoppiatori standard: Acqua -15°C fino a +140°C

Accoppiatori TS: -15°C fino a +180°C

## CHART

Serie 20

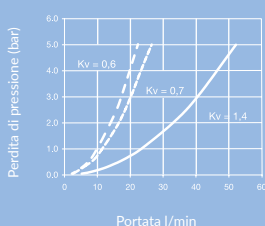

Serie 30

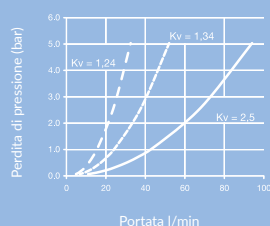

Serie 50

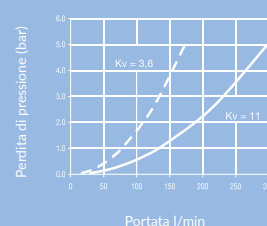

- Doppia valvola
- Valvola singola
- Nessuna valvola

## INNESTO DRITTO

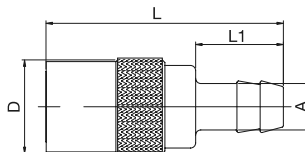

DN	SERIES			A	D	L	L1	
6	20	20K6V	20K6	6	18	46	17	10
		20K10V	20K10	10	18	51	22	10
		20K13V	20K13	13	18	51	22	10
9	30	30K10V	30K10	10	24	64	22	10
		30K13V	30K13	13	24	66,5	25	10
15	50	50K19V	50K19	19	32	89	32	5

## INNESTO CON BLOCCO DI SICUREZZA

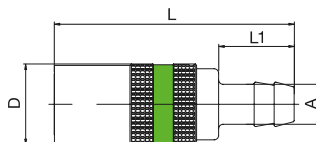

DN	SERIES			A	D	L	L1	
6	20	20K6V-S	20K6-S	6	18	54	17	10
		20K10V-S	20K10-S	10	18	59	22	10
9	30	30K10V-S	30K10-S	10	24	73	22	10
		30K13V-S	30K13-S	13	24	76	25	10

## INNESTO CON BLOCCO A SPINTA

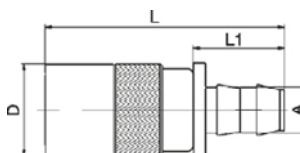

DN	SERIES			A	D	L	L1	
6	20	20K10V-PL	20K10-PL	10	18	58	28	10
9	30	30K10V-PL	30K10-PL	10	24	64,5	28	10
		30K13V-PL	30K13-PL	13	24	64,5	28	10

## INNESTO A 90°

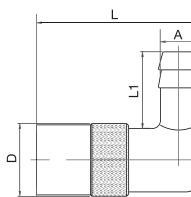

DN	SERIES	↙	↔	A	D	L	L1	📦
6	20	20K6V/90	20K6/90	6	18	40	19	10
		20K10V/90	20K10/90	10	18	40	22	10
9	30	30K10V/90	30K10/90	10	24	56	22	10
		30K13V/90	30K13/90	13	24	56	28,5	10
16	50	50K19V/90	50K19/90	19	32	77	32	5

## INNESTO A 90° CON BLOCCO DI SICUREZZA

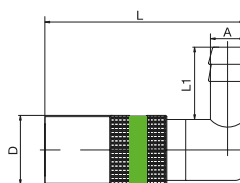

DN	SERIES	↙	↔	A	D	L	L1	📦
6	20	20K10V/90-S	20K10/90-S	10	18	52,5	22	10
9	30	30K10V/90-S	30K10/90-S	10	24	68,5	22	10
		30K13V/90-S	30K13/90-S	13	24	68,5	28,5	10

## INNESTO A 90° CON BLOCCO A SPINTA

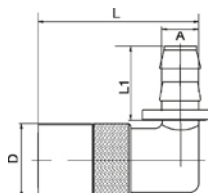

DN	SERIES	↙	↔	A	D	L	L1	📦
6	20	20K10V-90-PL	20K10-90-PL	10	18	40,5	28	10
	30	30K10V-90-PL	30K10-90-PL	10	23	61,5	28	10
9		30K13V-90-PL	30K13-90-PL	13	23	61,5	28	10

## INNESTO A 45°

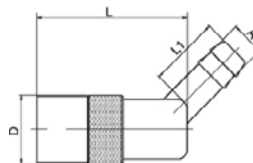

DN	SERIES	↻	↔	A	D	L	L1	📦
6	20	20K6V/45	20K6/45	6	18	55,5	19	10
		20K10V/45	20K10/45	10	18	55,5	22	10
9	30	30K10V/45	30K10/45	10	24	71	22	10
		30K13V/45	30K13/45	13	24	75	25	10
15	50	50K19V/45	50K19/45	19	32	77	30	5

## INNESTO A 45° CON BLOCCO DI SICUREZZA

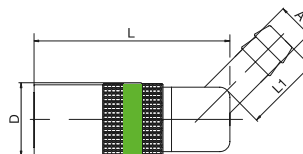

DN	SERIES	↻	↔	A	D	L	L1	📦
6	20	20K10V/45-S	20K10/45-S	10	18	52,5	22	10
9	30	30K10V/45-S	30K10/45-S	10	24	65,5	22	10
		30K13V/45-S	30K13/45-S	13	24	65,5	25	10

## INNESTO A 45° CON BLOCCO A SPINTA

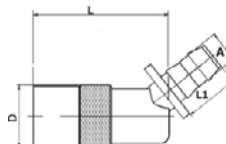

DN	SERIES	↻	↔	A	D	L	L1	📦
6	20	20K10V-45-PL	20K10-45-PL	10	18	40,5	28	10
9	30	30K10V-45-PL	30K10-45-PL	10	23	61,5	28	10
		30K13V-45-PL	30K13-45-PL	13	23	61,5	28	10

## INNESTO FILETTATO - MASCHIO

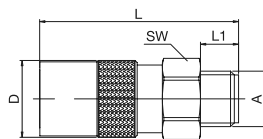

DN	SERIES	↺	↔	A	D	L	L1	SW	📦
6	20	20KUR1/4V	20KUR1/4	G1/4	18	38	9	17	10
		20KUR3/8V	20KUR3/8	G3/8	18	38	9	19	10
9	30	30KUR1/4V	30KUR1/4	G1/4	24	48,5	9	22	10
		30KUR3/8V	30KUR3/8	G3/8	24	48,5	9	22	10
		30KUR1/2V	30KUR1/2	G1/2	24	51,5	12	22	10
15	50	50KUR1/2V	50KUR1/2	G1/2	32	73	12	30	10
		50KUR3/4V	50KUR3/4	G3/4	32	77	16	30	5

## INNESTO FILETTATO - MASCHIO CON BLOCCO DI SICUREZZA

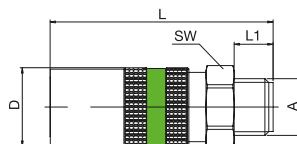

DN	SERIES	↺	↔	A	D	L	SW	📦
6	20	20KUR1/4V-S	20KUR1/4-S	G1/4	18	51,5	17	10
		20KUR3/8V-S	20KUR3/8-S	G3/8	18	51,5	19	10
9	30	30KUR1/4V-S	30KUR1/4-S	G1/4	24	67	22	10
		30KUR3/8V-S	30KUR3/8-S	G3/8	24	67	22	10
		30KUR1/2V-S	30KUR1/2-S	G1/2	24	70	22	10

## INNESTO FILETTATO - FEMMINA

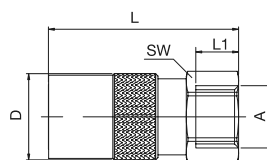

DN	SERIES	↺	↔	A	D	L	L1	SW	📦
6	20	20KIR1/8V	20KIR1/8	G1/8	18	40	10	17	10
		20KIR1/4V	20KIR1/4	G1/4	18	40	10	17	10
9	30	20KIR3/8V	20KIR3/8	G3/8	18	44	10	19	10
		30KIR1/4V	30KIR1/4	G1/4	24	51,5	10	21	10
		30KIR3/8V	30KIR3/8	G3/8	24	51,5	10	21	10

## PONTE DI INNESTO

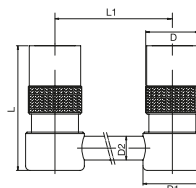

DN	SERIES	↔	A	D	L	D1	D2	L1	📦
6	20	20K125		18	42	20	8	125	1
		20K250		18	42	20	8	250	1
		20K500		18	42	20	8	500	1
9	30	30K125		24	58	26	10	125	1
		30K250		24	58	26	10	250	1
		30K500		24	58	26	10	500	1
15	50	50K160		32	78	36	14	160	1
		50K315		32	78	36	14	315	1
		50K500		32	78	36	14	500	1

## INNESTO CON RACCORDO

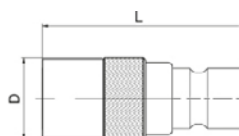

DN	SERIES	↔	↔	PLUG SERIES	D	L	📦
6	20	20K30NV	20K30N	30	18	50,5	10
9	30	30K20NV	30K20N	20	24	52,5	10

## INNESTO CIECO

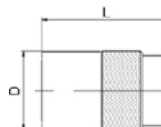

DN	SERIES	↔	D	L	📦
6	20	20K	18	30	10
9	30	30K	24	37	10



## RACCORDO MASCHIO

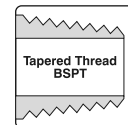
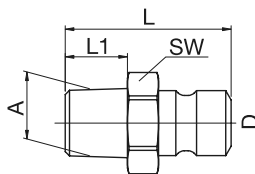
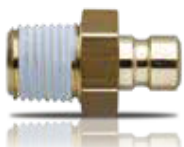

DN	SERIES	↔	↔	A	D	L	L1	SW	📦
6	20		20NM10	M10x1	9,4	23	8	13	25
			20NR1/8	R1/8	9,4	24	9	13	25
			20NR1/4	R1/4	9,4	29	12	16	25
		20NR1/4V	R1/4	9,4	29	14	16	25	
			20NR3/8	R3/8	9,4	30	12	19	25
9	30		30NR1/8	R1/8	13,5	29,5	20,5	14	25
		30NR1/4V	30NR1/4	R1/4	13,5	34	12	16	25
		30NR3/8V	30NR3/8	R3/8	13,5	34	12	19	25
			30NR1/2	R1/2	13,5	39	17	24	10
15	50		50NR1/2	R1/2	19,8	44	17	22	10
			50NR3/4	R3/4	19,8	45	19	29	10

## RACCORDO REGOLABILE

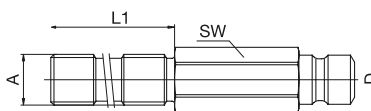

DN	SERIES	↔	A	D	L	L1	SW	📦
6	20	20NR1/8/100	G1/8	9,4	100	60	11	10
		20NR1/4/100	G1/4	9,4	100	60	14	10
9	30	30NR1/4/100	G1/4	13,5	100	60	14	10
		30NR3/8/100	G3/8	13,5	100	60	17	10

## RACCORDO PROLUNGATO FILETTATO

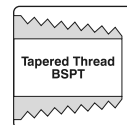
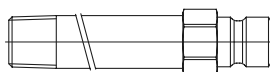

DN	SERIES	↔	A	D	L	L1	SW	📦
6	20	20N50	R1/8	9,4	50	9	11	10
		20N50-1/4	R1/4	9,4	50	12	14	10
		20N100	R1/8	9,4	100	9	11	10
		20N100-1/4	R1/4	9,4	100	12	14	10
		20N150	R1/8	9,4	150	9	11	10
		20N150-1/4	R1/4	9,4	150	12	14	10
		20N200	R1/8	9,4	200	9	11	10
		20N200-1/4	R1/4	9,4	200	12	14	10
		20N250	R1/8	9,4	250	9	11	10
9	30	30N50	R1/4	13,5	50	12	15	10
		30N100	R1/4	13,5	100	12	15	10
		30N150	R1/4	13,5	150	12	15	10
		30N200	R1/4	13,5	200	12	15	10
		30N250	R1/4	13,5	250	12	15	10

## RACCORDO MASCHIO A 90°

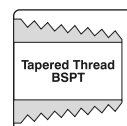
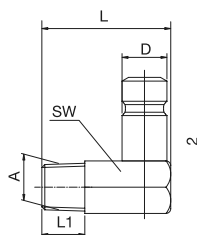

DN	SERIES	↔	A	D	L	L1	L2	SW	📦
6	20	20NM10/90	M10x1	9,4	27	9	28,5	11	25
		20NR1/8/90	R1/8	9,4	27	9	28,5	11	25
		20NR1/4/90	R1/4	9,4	27	9	28,5	11	25
9	30	30NR1/4/90	R1/4	13,5	34	9	32	15	25
		30NR3/8/90	R3/8	13,5	34	9	32	15	25

## RACCORDO CON PORTAGOMMA

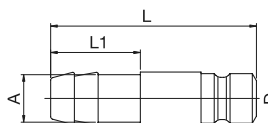

DN	SERIES	↔	A	D	L	L1	📦
6	20	20N10	10	9,4	39	22	25
		20N13	13	9,4	39	22	25
9	30	30N10	10	13,4	41	25	25
		30N13	13	13,4	41	25	25
15	50	50N19	19	13,4	41	25	25

## RACCORDO CON BLOCCO A SPINTA

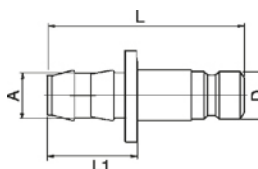

DN	SERIES	↔	A	D	L	L1	📦
6	20	20N10-PL	10	9,4	44	28	10
9	30	30N10-PL	10	13,5	44	28	10
		30N13-PL	13	13,5	44	28	10

## RACCORDO FEMMINA

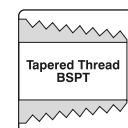
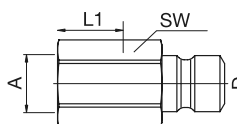

DN	SERIES	↔	A	D	L	L1	SW	📦
6	20	20NR1/8I	G1/8	9,4	28	11	13	25
		20NR1/4I	G1/4	9,4	32	13	16	25
		20NR3/8I	G3/8	9,4	34	13	19	25
9	30	30NR1/4I	G1/4	13,5	37	13	16	25
		30NR3/8I	G3/8	13,5	39	13	19	25

## RACCORDO DOPPIO

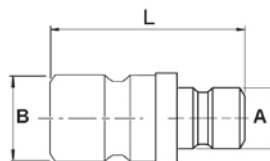

DN		A SERIES	B SERIES	L	
6	2020DB	20	20	31	10
	2030DB			31	10
9	3030DB	30	30	34	10

## GUARNIZIONI DI RICAMBIO PER INNESTI

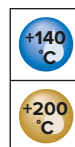

PART N°	SERIES	S	
200V	20	6	10
300V	30	9	10
500V	50	16	10



[www.eleNorm.com](http://www.eleNorm.com)